



**MOTORES TRIFÁSICOS MGM  
CON ENCODER INCORPORADO**



**SERIE SAE**

**SAE - B3**

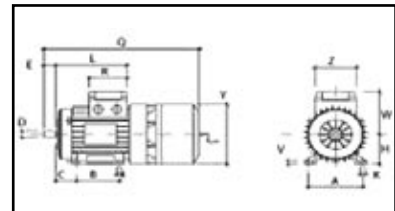

**SAE - B5**

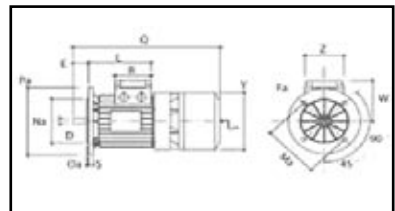

**SAE - B14**

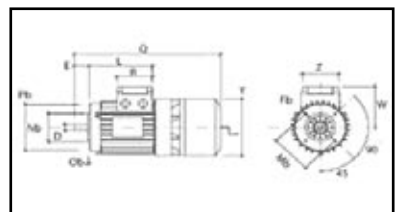

**SAE 160/180 /200 /225 B3**

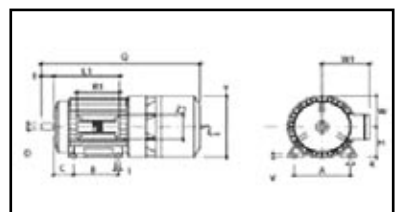

**CAJA BORNES DOBLE**

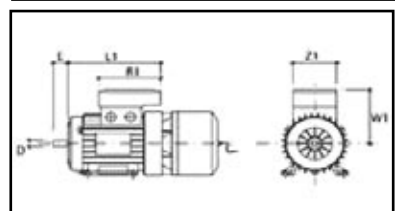

**EJE**

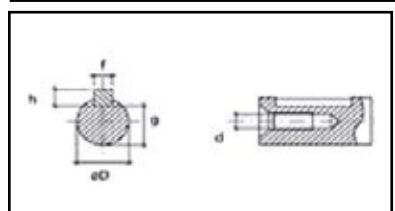

| TIPO   | 71   | 80   | 90S  | 90L  | 100L | 112M | 132S | 132M | 160M | 160L | 180L | 200L | 225S  | 225M  |
|--------|------|------|------|------|------|------|------|------|------|------|------|------|-------|-------|
| A      | 112  | 125  | 140  | 140  | 160  | 190  | 216  | 216  | 254  | 254  | 279  | 318  | 356   | 356   |
| B      | 90   | 100  | 100  | 125  | 140  | 140  | 140  | 178  | 210  | 254  | 279  | 305  | 286   | 311   |
| C      | 45   | 50   | 56   | 56   | 63   | 70   | 89   | 89   | 108  | 108  | 121  | 133  | 149   | 149   |
| D*     | 14   | 19   | 24   | 24   | 28   | 28   | 38   | 38   | 42   | 42   | 48   | 55   | 60    | 60    |
| d (M)  | M5   | M6   | M8   | M8   | M10  | M10  | M12  | M12  | M16  | M16  | M16  | M16  | M16   | M16   |
| E*     | 30   | 40   | 50   | 50   | 60   | 60   | 80   | 80   | 110  | 110  | 110  | 110  | 140   | 140   |
| Fa     | 9,5  | 11,5 | 11,5 | 11,5 | 14   | 14   | 14   | 14   | 18   | 18   | 18   | 18   | 18,5  | 18,5  |
| Fb (M) | M6   | M6   | M8   | M8   | M8   | M8   | M10  | M10  |      |      |      |      |       |       |
| f      | 5    | 6    | 8    | 8    | 8    | 8    | 10   | 10   | 12   | 12   | 14   | 16   | 18    | 18    |
| g      | 11   | 15,5 | 20   | 20   | 24   | 24   | 33   | 33   | 37   | 37   | 42,5 | 49   | 53    | 53    |
| H      | 71   | 80   | 90   | 90   | 100  | 112  | 132  | 132  | 160  | 160  | 180  | 200  | 225   | 225   |
| h      | 5    | 6    | 7    | 7    | 7    | 7    | 8    | 8    | 8    | 8    | 9    | 10   | 11    | 11    |
| I      | 7    | 10   | 10   | 10   | 12   | 12   | 12   | 12   | 14,5 | 14,5 | 15   | 18,5 | 18    | 18    |
| K      | 10,5 | 14   | 14   | 14   | 16   | 16   | 22   | 22   | 24   | 24   | 24   | 30   | 33    | 33    |
| L      | 148  | 162  | 171  | 196  | 217  | 219  | 225  | 293  |      |      |      |      |       |       |
| L1     | 184  | 194  | 207  | 232  | 254  | 262  | 294  | 339  | 373  | 395  | 420  | 446  | 452   | 464,5 |
| Ma     | 130  | 165  | 165  | 165  | 215  | 215  | 265  | 265  | 300  | 300  | 300  | 350  | 400   | 400   |
| Mb     | 85   | 100  | 115  | 115  | 130  | 130  | 165  | 165  |      |      |      |      |       |       |
| Na     | 110  | 130  | 130  | 130  | 180  | 180  | 230  | 230  | 250  | 250  | 250  | 300  | 350   | 350   |
| Nb     | 70   | 80   | 95   | 95   | 110  | 110  | 130  | 130  |      |      |      |      |       |       |
| Oa     | 3,5  | 3,5  | 3,5  | 3,5  | 4    | 4    | 4    | 4    | 5    | 5    | 5    | 5    | 5     | 5     |
| Ob     | 2,5  | 3    | 3    | 3    | 3,5  | 3,5  | 3,5  | 3,5  |      |      |      |      |       |       |
| Pa     | 160  | 200  | 200  | 200  | 250  | 250  | 300  | 300  | 350  | 350  | 350  | 400  | 450   | 450   |
| Pb     | 105  | 120  | 140  | 140  | 160  | 160  | 200  | 200  |      |      |      |      |       |       |
| Q      | 344  | 380  | 412  | 436  | 487  | 505  | 606  | 644  | 732  | 776  | 860  | 885  | 975   | 996   |
| R      | 81   | 81   | 98,5 | 98,5 | 98,5 | 98,5 | 108  | 108  |      |      |      |      |       |       |
| R1     | 135  | 135  | 170  | 170  | 170  | 170  | 199  | 199  | 268  | 268  | 268  | 268  | 268   | 268   |
| S      | 10   | 12   | 12   | 12   | 14   | 14   | 15   | 15   | 15   | 15   | 15   | 15   | 16    | 16    |
| V      | 8    | 9,5  | 10,5 | 10,5 | 12,5 | 13,5 | 16   | 16   | 21   | 21   | 24   | 24   | 30    | 30    |
| W      | 102  | 113  | 127  | 127  | 138  | 158  | 198  | 198  | 165  | 165  | 188  | 188  | 215   | 215   |
| W1     | 120  | 131  | 148  | 148  | 162  | 176  | 210  | 210  | 246  | 246  | 266  | 266  | 321,5 | 321,5 |
| Y      | 145  | 160  | 180  | 180  | 196  | 218  | 265  | 265  | 324  | 324  | 357  | 357  | 430   | 430   |
| Z      | 75   | 75   | 98,5 | 98,5 | 98,5 | 98,5 | 108  | 108  |      |      |      |      |       |       |
| Z1     | 86   | 86   | 112  | 112  | 112  | 112  | 151  | 151  | 167  | 167  | 167  | 167  | 167   | 167   |

\* 225S-225M 2 polos D=55, E=110